

## WIRELESS DIGITAL INDICATORS (ZIGBEE)

INSPECTION  
CERTIFICATE

DATA  
OUTPUT



2508-10WL

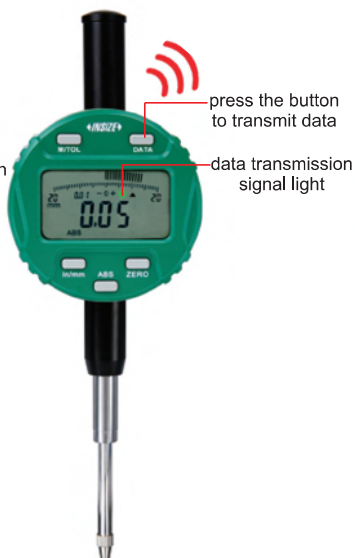

2509-25WL



2509-25PWL



2508-50WL

Unit: mm

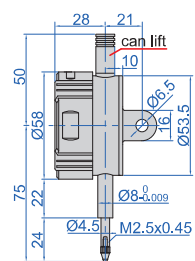

2508-10WL/2509-10WL

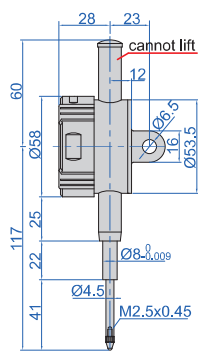

2508-25WL/2509-25WL

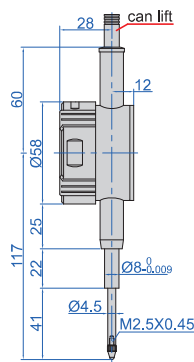

2508-25PWL/2509-25PWL

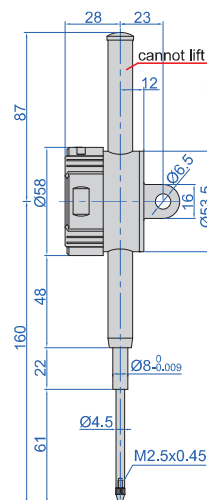

2508-50WL/2509-50WL

- Built-in wireless data transmission module, Zigbee signal
- Transmission distance is 10 meters (under the condition of no obstruction and no electromagnetic interference)
- Reading in digital and analog
- Display can be rotated by 320°
- Button function: on/off, zero, tolerance Go and No-Go display, data preset, measuring direction change, max./min./TIR measurement, inch/metric conversion, absolute/incremental measurement, data output
- Keep preset data and tolerance data in memory after restart
- Automatic power off (time is adjustable)
- Power: rechargeable Li-battery
- Optional accessory: receiver (code 7315-2/3/6/7/8/9), backs, contact points

analog pointer



alarm when over tolerance



max./min./TIR

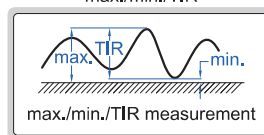

### Resolution 0.001mm/0.00005"

| Code         | Range       | Accuracy | Hysteresis | Maximum measuring force | Cap         | Remark    |
|--------------|-------------|----------|------------|-------------------------|-------------|-----------|
| 2508-10WL *  | 12.7mm/0.5" | 5µm      | 2µm        | 1.5N                    | can lift    | lug back  |
| 2508-25WL *  | 25.4mm/1"   | 5µm      | 3µm        | 2.2N                    | cannot lift | lug back  |
| 2508-50WL *  | 50.8mm/2"   | 6µm      | 3µm        | 2.5N                    | cannot lift | lug back  |
| 2508-10FWL * | 12.7mm/0.5" | 5µm      | 2µm        | 1.5N                    | can lift    | flat back |
| 2508-25FWL * | 25.4mm/1"   | 5µm      | 3µm        | 2.2N                    | cannot lift | flat back |
| 2508-50FWL * | 50.8mm/2"   | 6µm      | 3µm        | 2.5N                    | cannot lift | flat back |
| 2508-25PWL * | 25.4mm/1"   | 5µm      | 3µm        | 2.2N                    | can lift    | flat back |
| 2508-50PWL * | 50.8mm/2"   | 6µm      | 3µm        | 2.5N                    | can lift    | flat back |

cap lift



### Resolution 0.01mm/0.0005"

| Code         | Range       | Accuracy | Hysteresis | Maximum measuring force | Cap         | Remark    |
|--------------|-------------|----------|------------|-------------------------|-------------|-----------|
| 2509-10WL *  | 12.7mm/0.5" | 20µm     | 10µm       | 1.5N                    | can lift    | lug back  |
| 2509-25WL *  | 25.4mm/1"   | 20µm     | 10µm       | 2.2N                    | cannot lift | lug back  |
| 2509-50WL *  | 50.8mm/2"   | 30µm     | 10µm       | 2.5N                    | cannot lift | lug back  |
| 2509-10FWL * | 12.7mm/0.5" | 20µm     | 10µm       | 1.5N                    | can lift    | flat back |
| 2509-25FWL * | 25.4mm/1"   | 20µm     | 10µm       | 2.2N                    | cannot lift | flat back |
| 2509-50FWL * | 50.8mm/2"   | 30µm     | 10µm       | 2.5N                    | cannot lift | flat back |
| 2509-25PWL * | 25.4mm/1"   | 20µm     | 10µm       | 2.2N                    | can lift    | flat back |
| 2509-50PWL * | 50.8mm/2"   | 30µm     | 10µm       | 2.5N                    | can lift    | flat back |

spindle lift knob is included



\* Supplied with manufacturer inspection certificate

application

